

Appendix One - Details

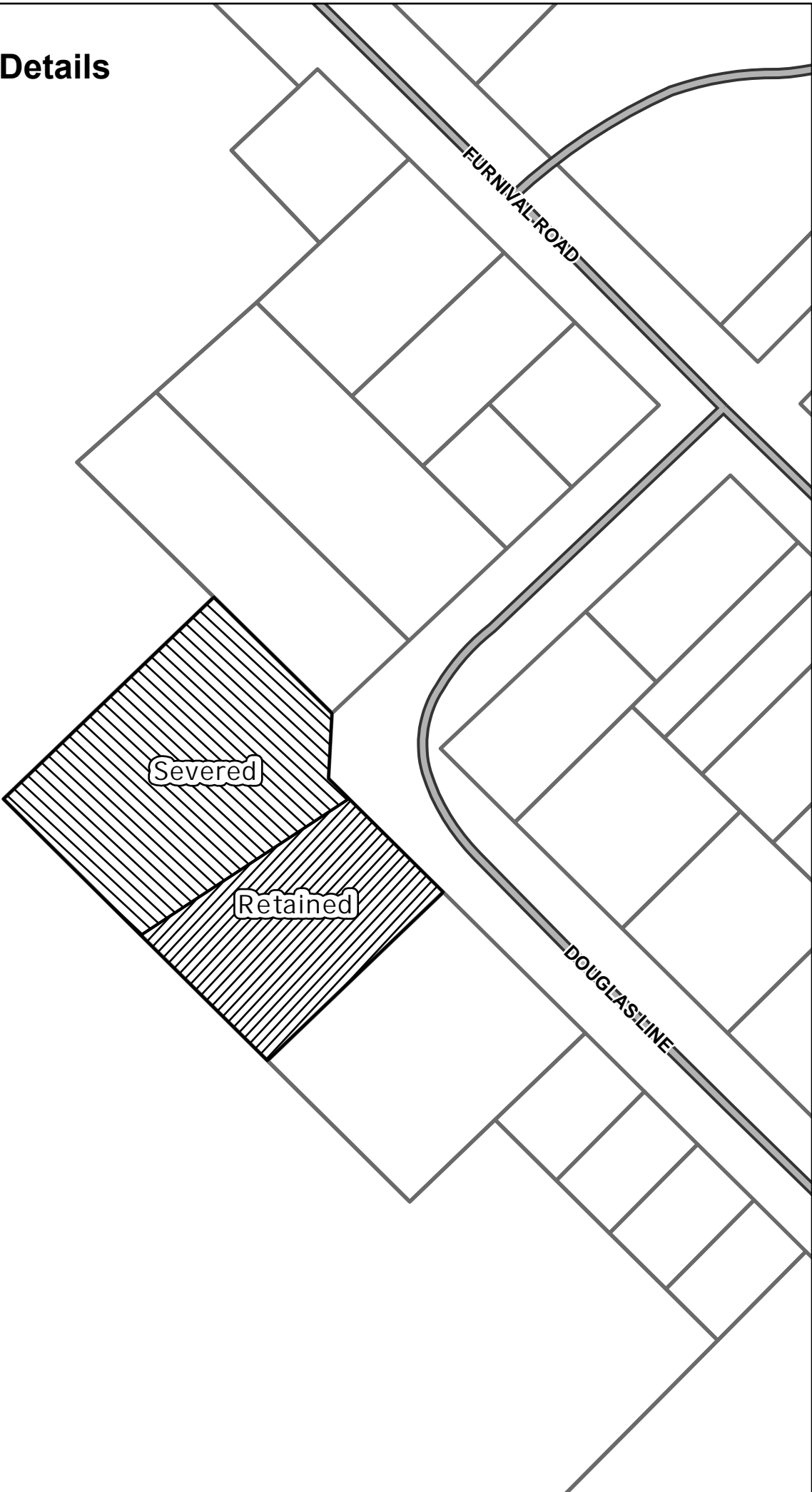

Location Map



Subject Site: 22202 Douglas Line
File Number: E 72-2022
Owner: Jermie and Mchelle Bégin
Planner: Unknown
CA: Lower Thames Conservation Authority
Created By: PC
Date: 09/07/2022
Municipality of West Elgin

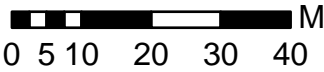

The Corporation of the County Elgin
Prepared By: Planning and Development

Legend

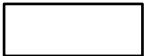

Subject Site



Severed



Retained



Elgin Road Network

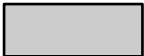

Buildings